

MAKING DORSET'S COASTAL ARCHAEOLOGY MORE ACCESSIBLE

Steve Wallis

Senior Archaeologist, Dorset Council

and

Richard McConnell

Director, Context One Heritage & Archaeology



REDISCOVERING HIGH ANGLE BATTERY







The 'bigger picture'

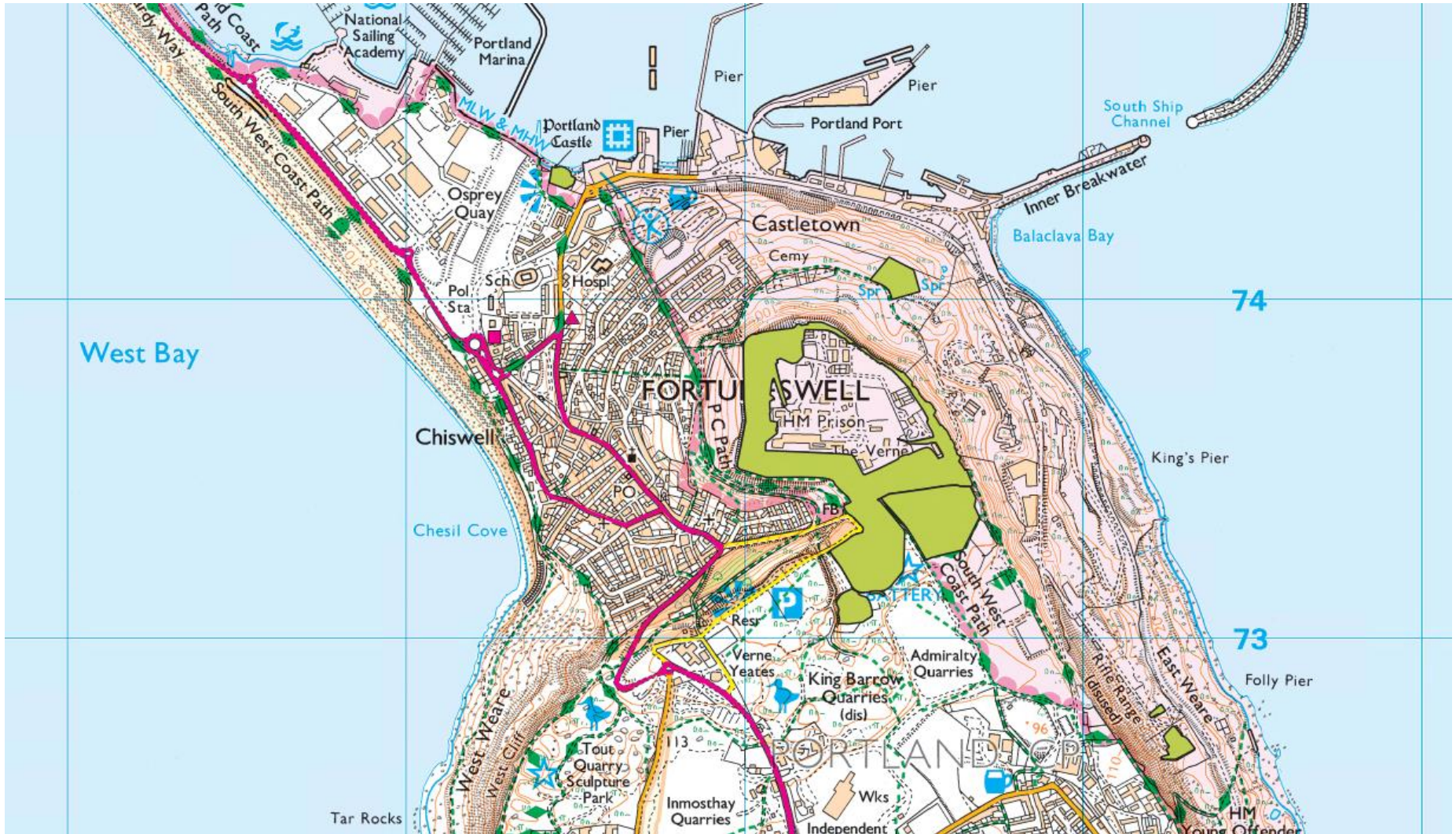

Areas in green are Scheduled Monuments.

© Crown copyright [and database rights] [2023] 010060963.
Use of this data is subject to terms and conditions. This map is not definitive and has no legal status.

The issues



The public consultation – the Ghost Tunnels

Q7 The Tunnels We are considering closing all of the tunnels for safety reasons and to get drone footage of all tunnels to have a photographic record that would be available online. What is your view on this? Credit: Historic England Archive

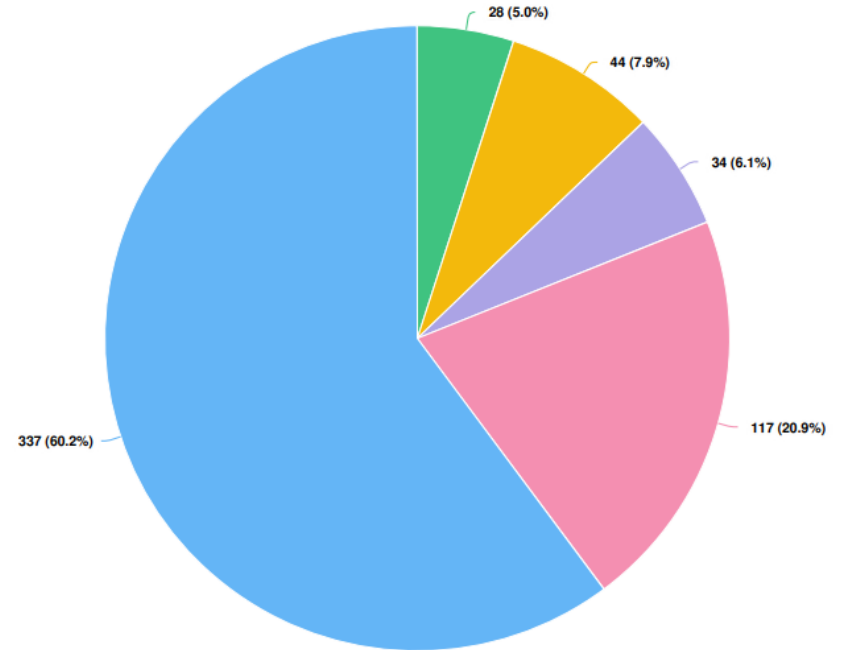

Question options

● Definitely disagree ● Somewhat disagree ● Neither agree nor disagree ● Somewhat agree ● Definitely agree

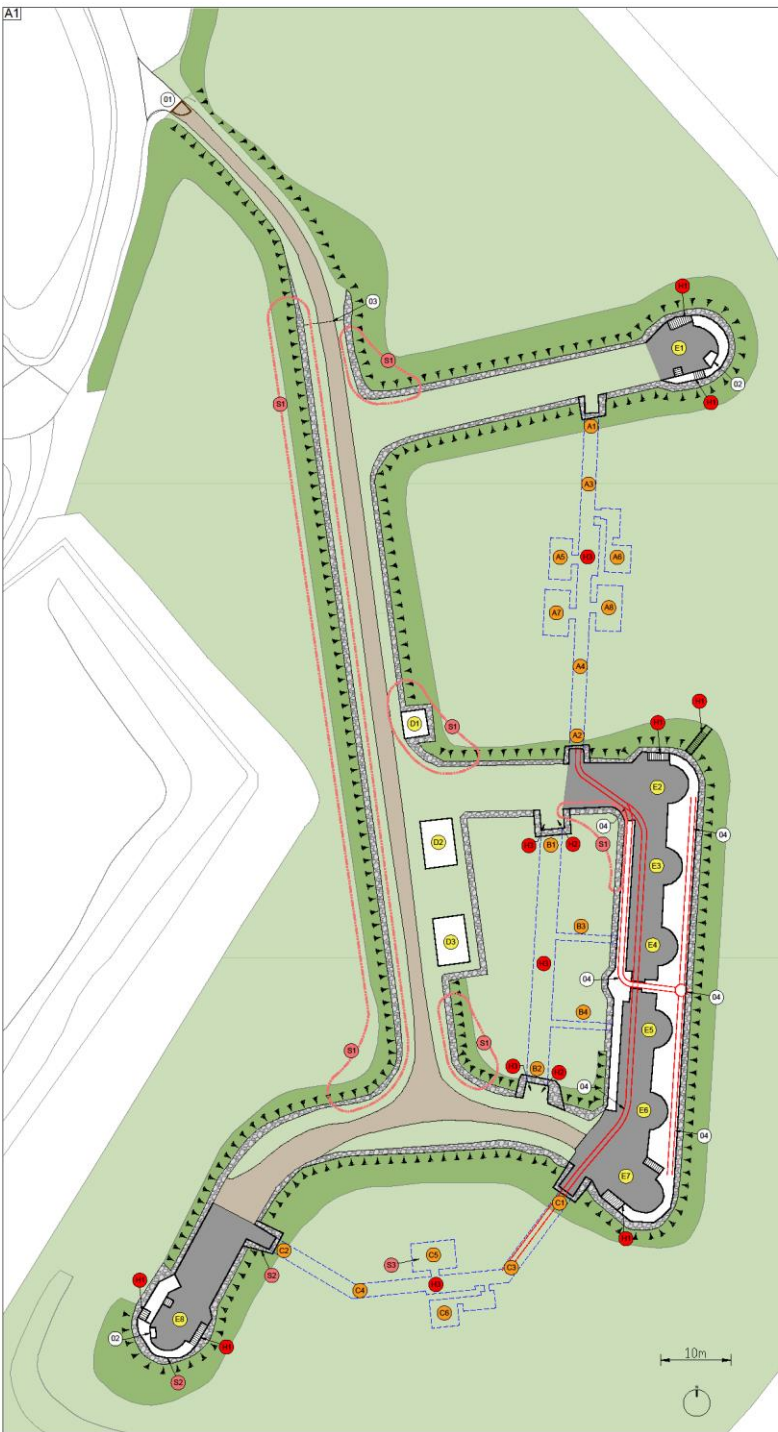

The copyright in this drawing is vested in Natural Environment Team, Dorset Council and may not be reproduced without express permission.

00

You are permitted to use this data solely to enable you to reproduce, or amend with, the information that provided you with the data. You are not permitted to copy, sub-license, distribute or sell any of the data to third parties in any form.

© Crown copyright and database rights 2023 Ordnance Survey 100050885.

- Key**
- Existing buildings and structures
 - Existing underground structures
 - Existing vegetation - gentle gradient
 - Existing vegetation - steep gradient/landform
 - Existing dirt paths
 - Existing concrete surfaces
 - Existing stone retaining walls
 - Existing field gates - maintenance access
 - Existing narrow gauge railway line

- A** Tunnel A (individual areas marked as A1-A8)
 - B** Tunnel B (individual areas marked as B1-B4)
 - C** Tunnel C (individual areas marked as C1-C6)
- Buildings (individual buildings marked D1-D3)**
- D1** Building 1 - damaged roof, seal up required
 - D2** Building 2 - minor damage, seal up required
 - D3** Building 3 - minor damage, seal up required
- Emplacements (individual areas marked as E1-E8)**
- Health & Safety**
- Damaged steps & overgrown vegetation
 - Damaged handrails
 - Rubble/debris on the pedestrian routes
- Damage to structures and walls**
- Wall and bank erosion within area
 - Missing capping stones
 - Damaged structures
- Other items:**
- Existing field gate
 - Latrine building
 - Historic entrance to the Battery
 - Narrow gauge railway line

A - For Information Issue - 08/06/2023

For Information			
Natural Environment Team County Hall, Collyer Quay, Dorchester, Dorset DT1 1UJ Telephone 01306 524333			
www.dorsetcouncil.gov.uk			
Client: Dorset Council Place Services			
Address: The Verne High Angle Battery, Portland			
Drawing No: Site Plan As Existing			
Issue	Date	Drawn By	Checked
001	08/06/23	LM	LM
Authorised	Drawn	Checked	Approved
		LM	A





Great Barrow.

Corybery hills.

Small Platform

Weymouth

The Lutter

Weymouth.



context one
HERITAGE & ARCHAEOLOGY



ST NICHOLAS STREET

MFA BOWL

HOLY TRINITY

TOWN BRIDGE

NORTH QUAY

CHAPEL HAY





Old High Street, Weymouth
Hope United Reform Church
Trinity Street, Weymouth
January 28th 2023
Saturday
2pm
£2 on the door
£5a/outrise

